

CODE: **AWO224** v1.1/III
 NAME: **Enclosure 17/EXP/SAT**

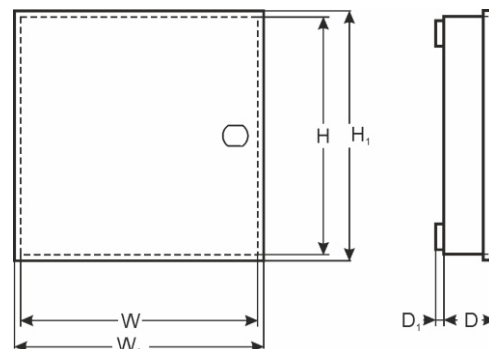

APPLICATION

1. Modules:

SATEL: INT-E, INT-PP, ACCO-NT, ACCO-KP, ACCO-KPWG, ACCO-KP-PS, ACCO-KPWG-PS.

2. Buffer power supply units:

SATEL: APS-412, APS-612.

PULSAR: PSB251215, PSB351225, PSB501235, PSB751250.

TECHNICAL PARAMETERS

External dimensions of the enclosure:	W=320, H=305, D+D ₁ =100+8 [\pm 2mm]
External dimensions of the front panel:	W ₁ =325, H ₁ =310 [\pm 2mm]
Weight net/gross:	2,05kg / 2,30kg [\pm 0,1kg]
Battery space:	17Ah/12V Sealed Lead Acid (SLA)
Operating environment:	2nd environmental class, -10°C+ 40°C
Material description:	sheet steel DC01, thickness: 0,7mm, corrosion protection, color: RAL 9003
Destination:	indoor
Tamper protection:	1 x microswitch: opening of the enclosure, 0,5A@50V/DC max. NC/NO - normally closed contacts / normally open
Closing:	screwed x 4
Notes:	optional: lockable, distance from wall (mounting surface) - 8mm
Declaration, warranty:	RoHS, 2 year from the production date